

# STRATFORD CITY

2003-2012, Stratford City, London, United Kingdom

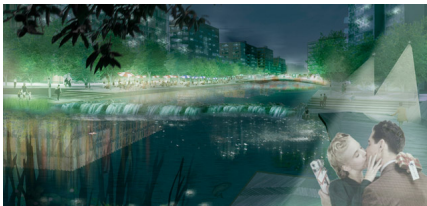
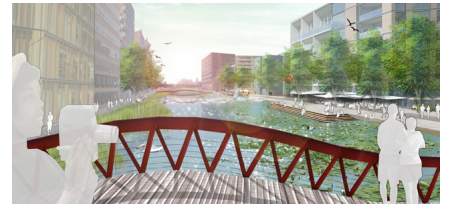

Stratford City will be a major new urban centre in the heart of east London and a major site for the 2012 Olympics. Water plays a major part in this West 8 urban plan. A gently curving boulevard will act as a central spine to the entire development. Animated by continuous pedestrian movement and flanked on one side by major retail facilities and on the other by London's newest office district, it has the potential to become one of Europe's grandest streets. The adjacent individual neighbourhoods are set within a clear grid of streets, parks and open spaces and integrate seamlessly into the fabric of the surrounding area.

## client

Chelsfield plc, Stanhope plc, Continental Railways Ltd, Westfield, Firstbase

## partners

Arup Associates

## team

Maarten Buijs, Adriaan Geuze, Jerry van Eyck, Riette Bosch